

Section 3

Handrails, Dual Rail & Combination Rail

Information on handrail solutions for pedestrian support and guidance in addition to surface protection. Includes PVC-u, timber, stainless steel and aluminium options.

Handrails, Dual Rails & Combination Rail

Gradus handrails, Dual Rails and combination rail are designed to offer pedestrian guidance and support in addition to a level of surface protection.

Designed for use in interior, horizontal circulation areas, they are suitable for use in a wide range of environments including education, healthcare, commercial office and transport.

The style of profile selected will depend on the types and levels of both pedestrian and wheeled traffic.

Handrails can also be combined with other profiles from the range to provide a complete protection solution.

Product Options



Handrail

- Traditional handrail design available in a range of materials and finishes including PVC-u, aluminium, timber and stainless steel
- Offers a comfortable, smooth, continuous grip
- Meets the guidance for dimensions in relation to grip diameter, distance from the wall and bracket clearance
- Primarily designed to offer pedestrian support with a small element of wall protection
- Meets the guidance set out in Health Building Notes 00-04 and 00-10 (Department of Health Estates & Facilities)



Dual Rail

- Combines a choice of traditional handrail with a PVC-u wall guard linked together with a choice of specialist brackets
- Designed to meet the specific needs in healthcare environments where pedestrian support is required in addition to protection against impact from wheeled traffic
- Meets the guidance set out in Health Building Notes 00-04 and 00-10 (Department of Health Estates & Facilities)

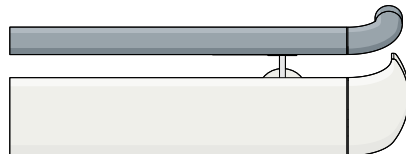

Combination Rail

- Features a handrail and wall guard element combined as a single profile
- Offers both direct and indirect protection against impact from wheeled traffic
- Features a comfortable grip and thumb groove to provide reassuring pedestrian support and guidance



Handrails, Dual Rails & Combination Rail

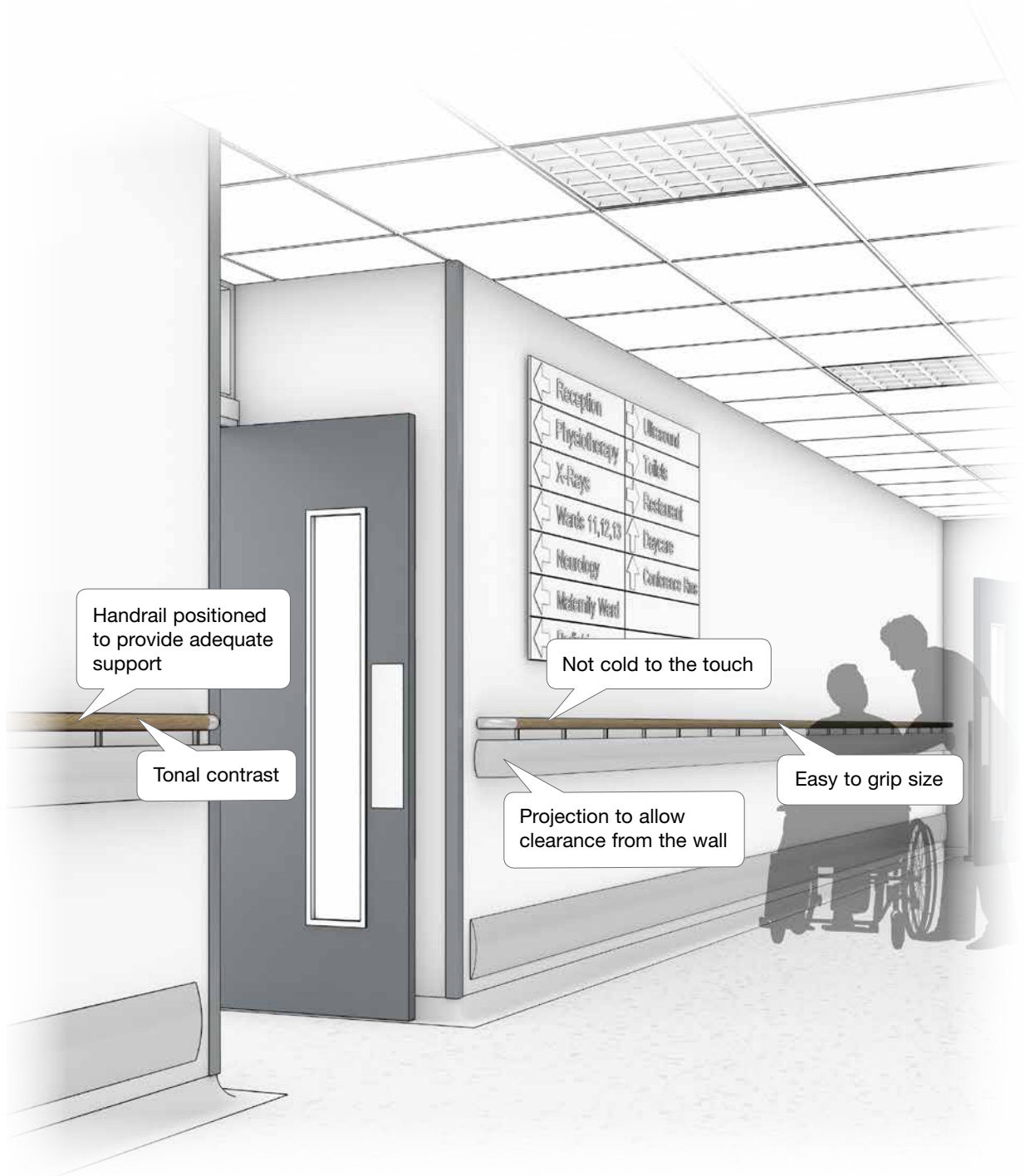

Section 03

Meets the requirements of Approved Document M & K refer to standards on page 84

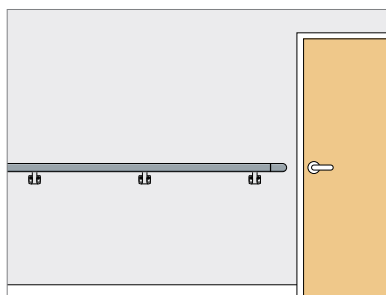

SHR40 Handrail
pedestrian guidance

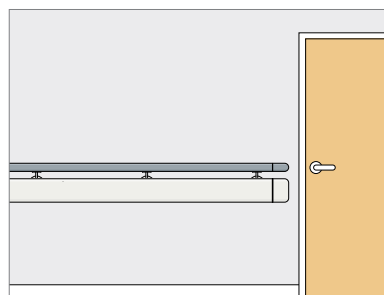

D200 Dual Rail
pedestrian guidance and impact protection

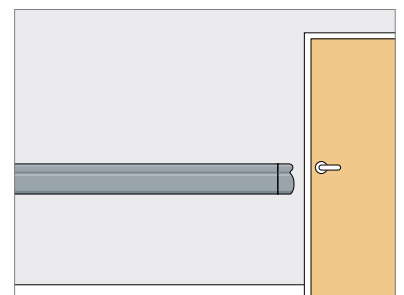

CHR160 Combination Rail
pedestrian guidance and impact protection

SHR40 Handrail

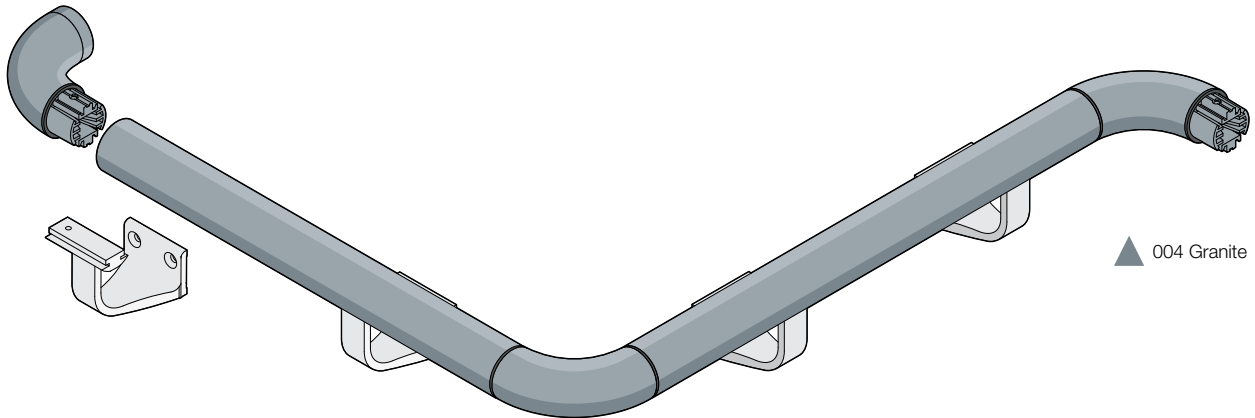

BIM Products available to download as BIM objects. www.gradus.com

- SHR40 handrails are designed to offer pedestrian guidance and support in addition to a level of surface protection
- Available in 3 options: SHR40P PVC-u cover, SHR40W wood effect aluminium and SHR40S silver anodised aluminium
- Suitable for use in a wide range of environments including healthcare, education and transport
- Handrails feature a smooth finish in line with HBN 00-04
- Reveals provide tight, neat joints and are made from a naturally bactericidal polymer that inhibits the growth of bacteria
- All options are designed to meet guidelines in HBN 00-10, HBN 00-04, BS 8300-2:2018 and Approved Documents K and M of The Building Regulations 2010
- Size: Supplied in 4.0m lengths
- Material: PVC-u, Aluminium

Features

SHR40P - Aluminium retainer with PVC-u covers and matching PVC-u accessories (see opposite)

- Colour: available in 32 colours - see pages 21 - 23 for colours and availability
- Accessories include reveal(s)

Components

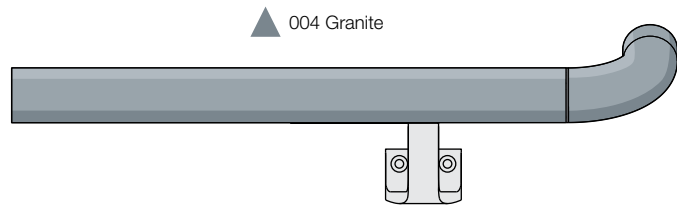

Standard bracket
SHR403

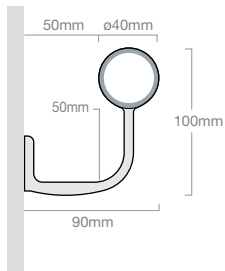

Stainless Steel bracket with cover
SA951

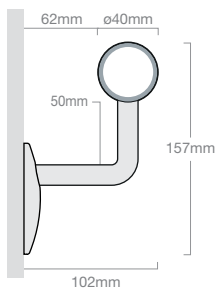

Stainless Steel bracket
SA959

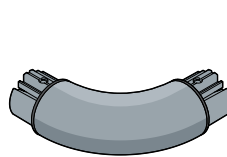
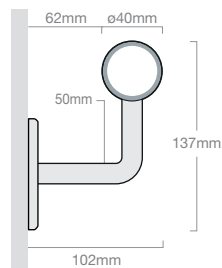

SHR402P
universal corner

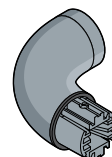

SHR404P
universal return

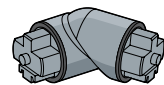

SHR408P
variable angle



SHR407
jointing splice



SHR406P
end stop

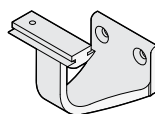

SHR403
mounting bracket
(anodised aluminium)

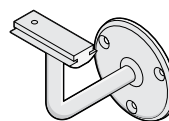

SA959
mounting bracket
(stainless steel)

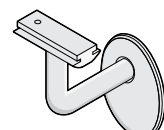

SA951
mounting bracket
(stainless steel)

SHR40 Handrail

Features

SHR40W - Aluminium handrail with wood effect finish with PVC-u accessories

- Colour: Handrail colour available in 5 wood effects see page 21 for availability and page 29 for larger colour swatches
- Accessories are available in 32 colours, see page 21 for colours and availability
- Recommended PVC-u accessories colour - Flint 032, Pebble 011 or Granite 004
- Accessories include reveal(s)

Standard bracket
SHR403

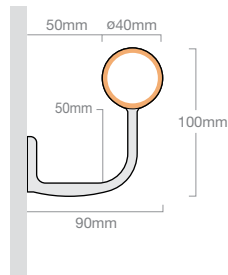

Stainless Steel bracket with cover
SA951

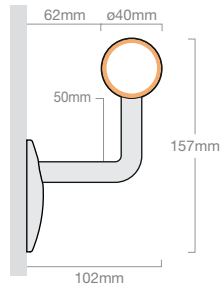

Stainless Steel bracket
SA959

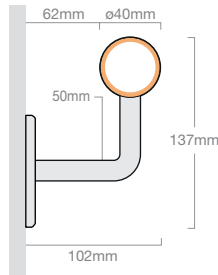

Components

▲ 061 Beech

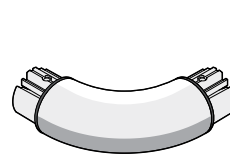
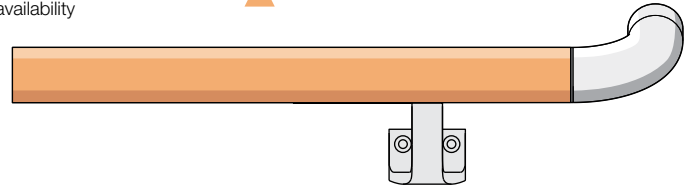

SHR402P
universal corner

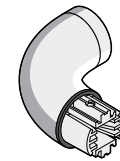

SHR404P
universal return

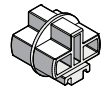

SHR407
jointing splice



SHR406P
end stop

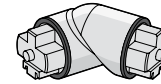

SHR408P
variable angle

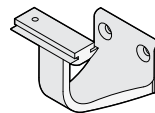

SHR403
mounting bracket
(anodised aluminium)

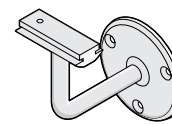

SA959
mounting bracket
(stainless steel)

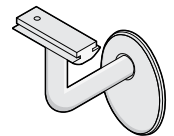

SA951
mounting bracket
(stainless steel)

Features

SHR40S - Silver anodised handrail with PVC-u accessories

- Colour: Handrail available in Silver Anodised finish
- Accessories are available in 32 colours, see page 21 for colours and availability
- Recommended PVC-u accessories colour - Flint 032
- Accessories include reveal(s)

Standard bracket
SHR403

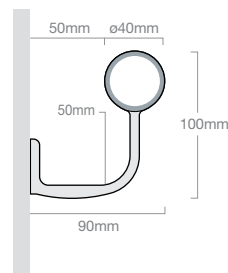

Stainless Steel bracket with cover
SA951

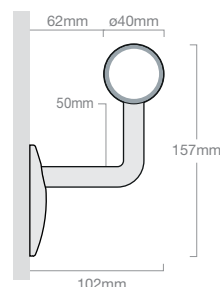

Stainless Steel bracket
SA959

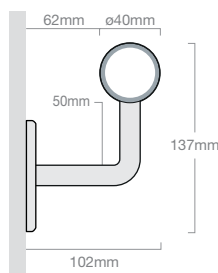

Components

▲ Silver Anodised

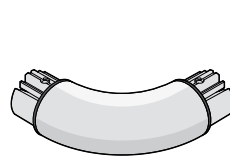
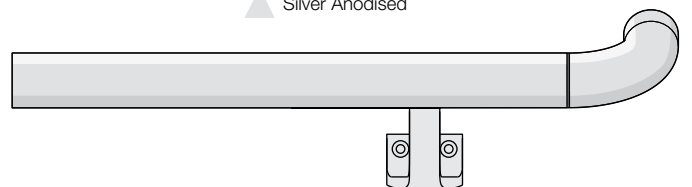

SHR402P
universal corner

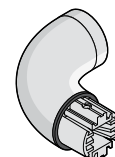

SHR404P
universal return

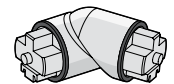

SHR408P
variable angle



SHR407
jointing splice



SHR406P
end stop

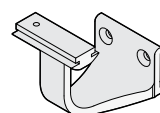

SHR403
mounting bracket
(anodised aluminium)

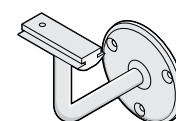

SA959
mounting bracket
(stainless steel)

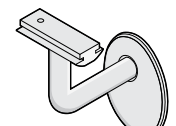

SA951
mounting bracket
(stainless steel)

THR450 Timber Handrail

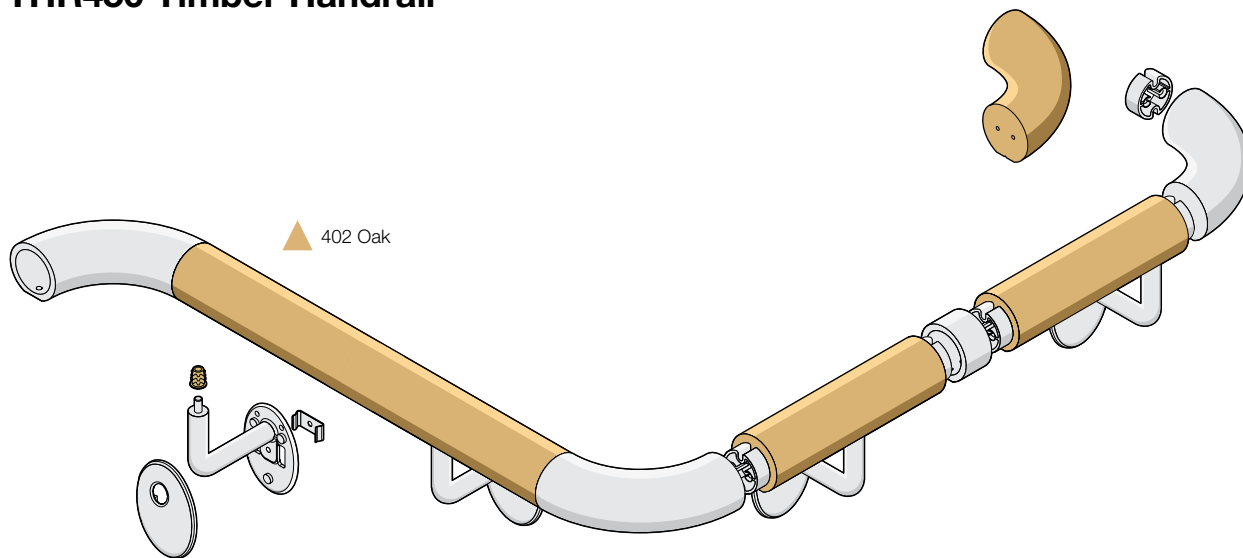

- Solid timber handrail with stainless steel or solid timber finishing accessories
- Supplied pre-lacquered – no on-site finishing required
- Timber handrail also forms part of D200T Dual Rail (see page 59)
- Colour: 4 timber options
- Size: Ash & Oak supplied in 3.6m lengths; Maple & Sapele 3.0m lengths
- Material: Timber, Stainless steel

Features

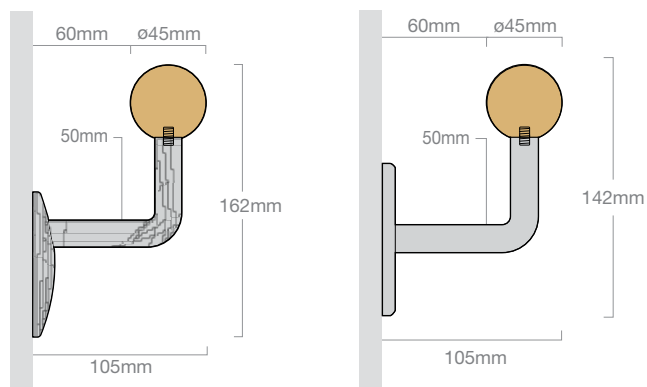

Components

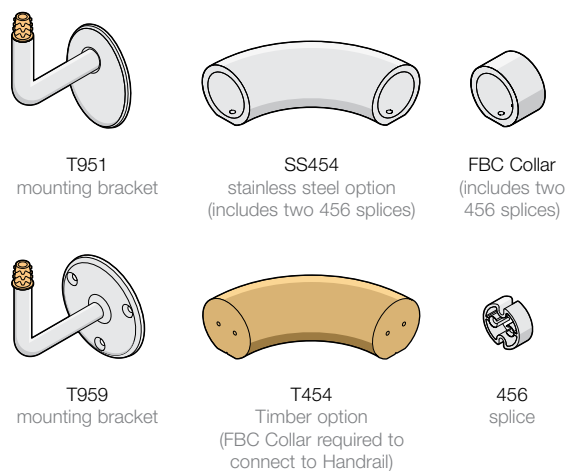

Timber options

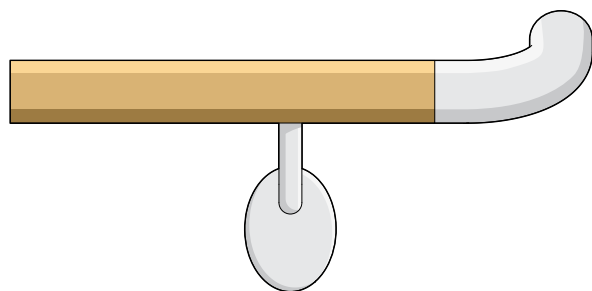

Light Reflectance Values shown are a guide only as wood is a natural product. Variations in colour & pattern will occur.

SSHR42 Stainless Steel Handrail

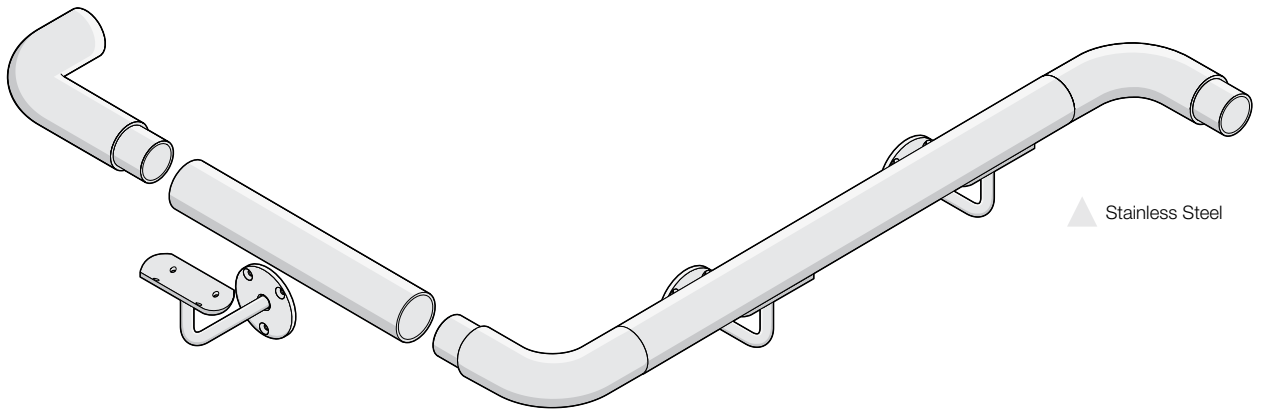

- Comprise stainless steel handrail, brackets and matching accessories
- Can be curved for bespoke applications (contact Gradus for radii information)
- Suitable for interior environments
- Colour: Satin or Polished finish
- Size: Supplied in 3.0m lengths
- Material: Stainless steel
- Complementary corner guards see 63

Features

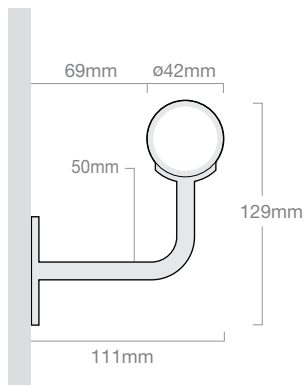

Components

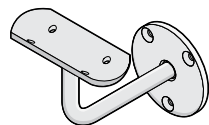

SSHR42/SBRKT
mounting bracket

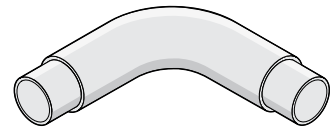

SSHR42/A90
inside/outside corner 90°

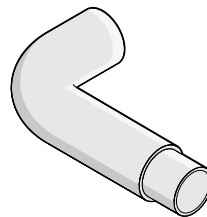

SSHR42/RET
wall return



SSHR42/EC
flat end cap

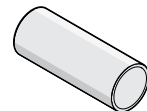

SSHR42/SPLICE
liner joint

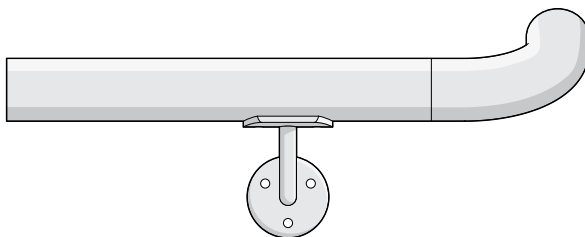

Finish



Stainless Steel LRV: 59.95

D200 Dual Rail

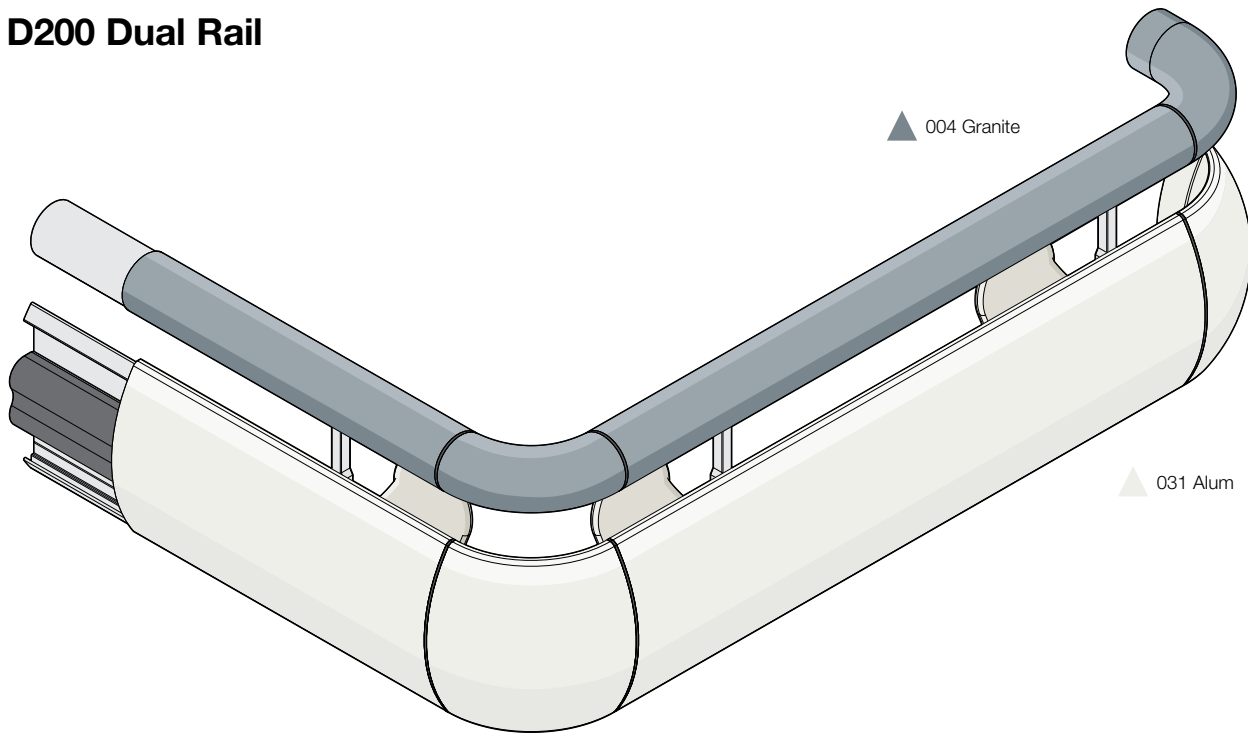

- Dual Rail provides the ideal solution where both a handrail and wall guard are required as a combined system
- Available in 4 options: D200P with PVC-u handrail, D200T with Timber handrail, D200W with wood effect aluminium handrail and D200S with silver anodised aluminium handrail
- Ideal for healthcare environments where pedestrian support is required in addition to protection against severe impact
- Reveals provide tight, neat joints and are made from a naturally bactericidal polymer that inhibits the growth of bacteria
- All options are designed to meet guidelines in HBN 00-10, HBN 00-04, BS 8300-2:2018 and Approved Documents K and M (see page 77 for details)
- Size: Supplied in 4.0m lengths
- Material: See individual product options

Features

D200P - PVC-u wall guard with PVC-u handrail and PVC-u accessories

- Colour: Wall Guard: All options available in 32 colours - see pages 21 - 23 for colours and availability
Handrail: D200P – as wall guard above
- Accessories include reveal(s)

Components

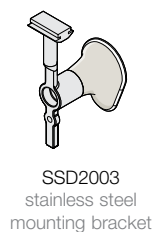
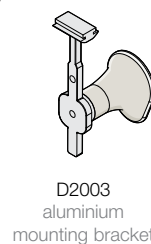
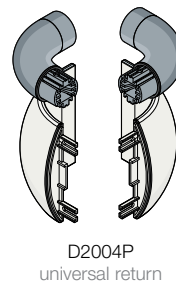
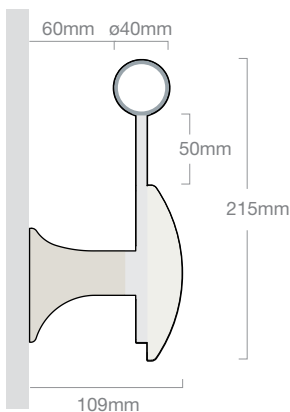
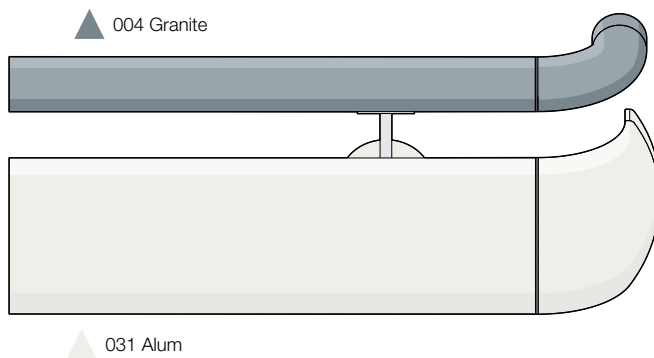

For multiple length handrail installations use splice SHR407 (page 54)
Should be used in conjunction with wall guard splice D200JS

D200 Dual Rail

D200T - PVC-u wall guard with timber handrail and stainless steel accessories

- Colour: Wall Guard: All options available in 32 colours see pages 21 - 23 for colours and availability
Handrail: available in 4 timbers see page 56 for details
- Wall guard accessories include reveal(s)

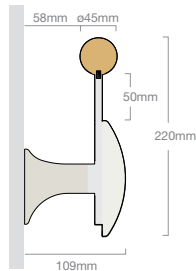
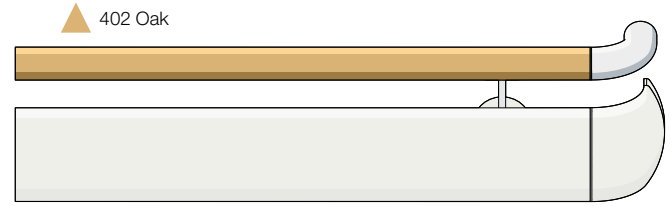

D2002EST
outside corner



D2002IST
inside corner

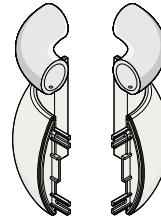

D2004ST
universal return

FBC Collar
(includes two 456 splices)

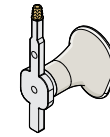

D2003T
aluminium
mounting bracket

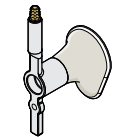

SSD2003T
stainless steel
mounting bracket

For multiple length handrail installations use FBC Collar in conjunction with wall guard splice D200JS

D200W - PVC-u wall guard with wood effect aluminium handrail and PVC-u accessories

- Colour: Wall Guard: All options available in 32 colours - see pages 21 - 23 for colours and availability
Handrail: available in 5 wood effects see page 29
- Accessories include reveal(s)

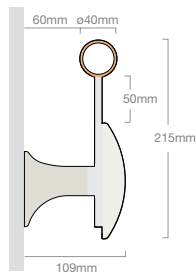
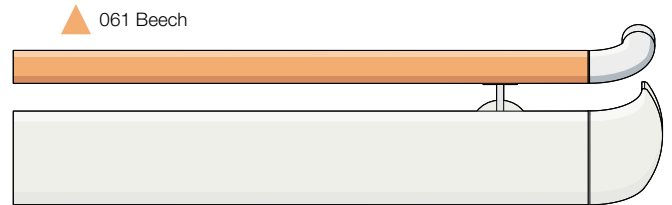

D2002ECP
outside corner

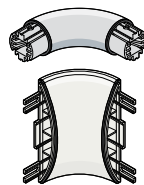

D2002ICP
inside corner

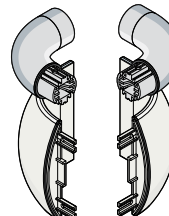

D2004CP
universal return

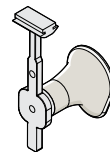

D2003
aluminium
mounting bracket

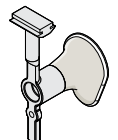

SSD2003
stainless steel
mounting bracket

For multiple length handrail installations use splice SHR407 (page 52) Should be used in conjunction with wall guard splice D200JS

D200S - PVC-u wall guard with silver anodised aluminium handrail and PVC-u accessories

- Colour: Wall Guard: All options available in 32 colours - see pages 21 - 23 for colours and availability
Handrail: available in Silver Anodised finish
- Accessories include reveal(s)

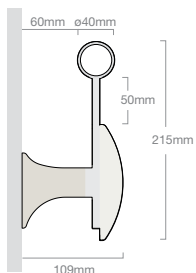
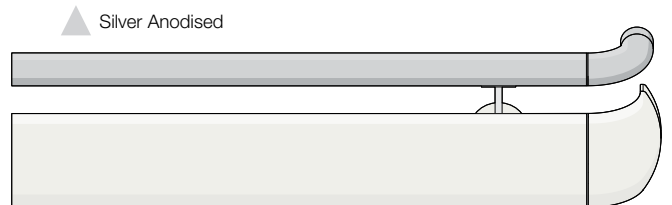

D2002ESP
outside corner

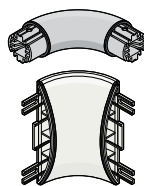

D2002ISP
inside corner

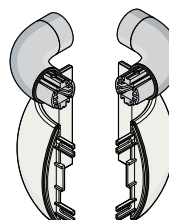

D2004SP
universal return

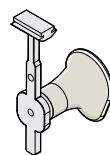

D2003
aluminium
mounting bracket

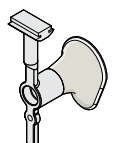

SSD2003
stainless steel
mounting bracket

For multiple length handrail installations use splice SHR407 (page 54) Should be used in conjunction with wall guard splice D200JS

CHR110 Combination Rail

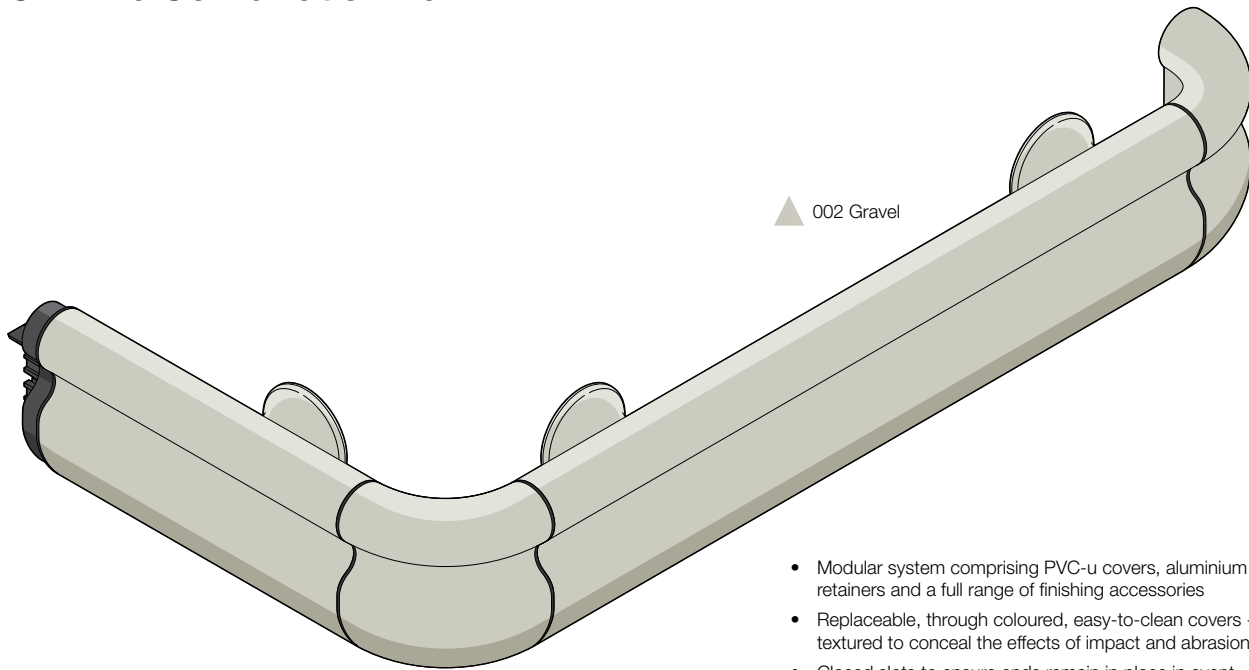

 Gradus is the largest UK manufacturer of wall protection profiles

- Modular system comprising PVC-u covers, aluminium retainers and a full range of finishing accessories
- Replaceable, through coloured, easy-to-clean covers - textured to conceal the effects of impact and abrasion
- Closed slots to ensure ends remain in place in event of severe high impact
- Reveals provide tight, neat joints and are made from a naturally bactericidal polymer that inhibits the growth of bacteria
- Colour: Available in 32 colour options – see pages 21 - 23 for colours and availability
- Size: Supplied in 4.0m lengths.
- Material: PVC-u, Aluminium

Components

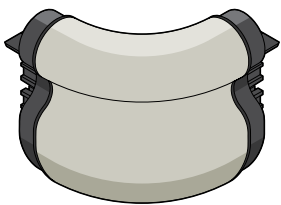

CHR1102EXT
outside corner
(including reveals)

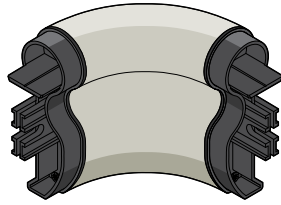

CHR1102INT
inside corner
(including reveals)



CHR1104L
left return
(including reveal)

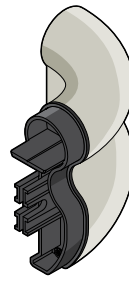

CHR1104R
right return
(including reveal)



CHR1103
mounting bracket
(supplied in colour 002 Gravel)

Features

Profile

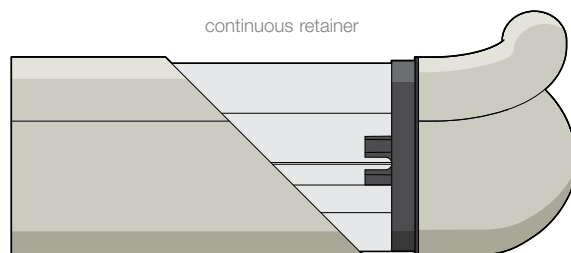
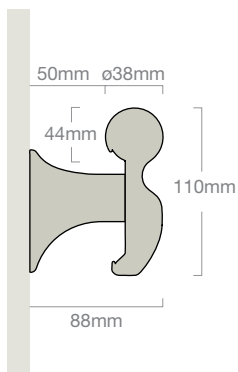

For multiple length installations use Wall Guard Splice D200JS

CHR160 Combination Rail

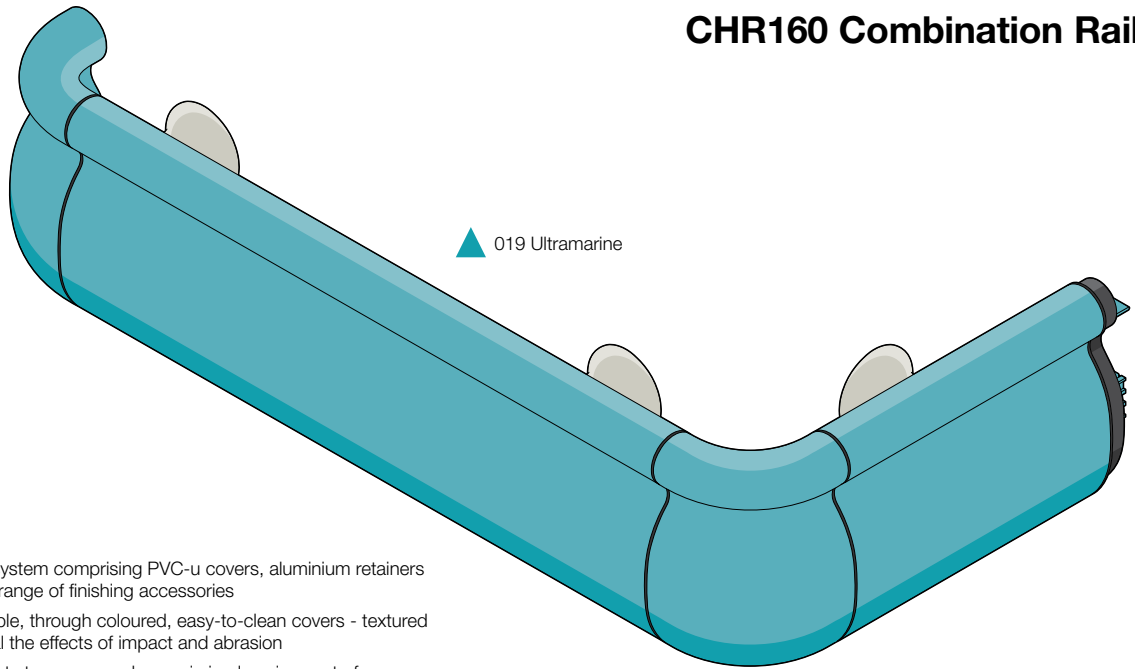

- Modular system comprising PVC-u covers, aluminium retainers and a full range of finishing accessories
- Replaceable, through coloured, easy-to-clean covers - textured to conceal the effects of impact and abrasion
- Closed slots to ensure ends remain in place in event of severe high impact
- Reveals provide tight, neat joints and are made from a naturally bactericidal polymer that inhibits the growth of bacteria
- Colour: Available in 32 colour options – see pages 21 - 23 for colours and availability
- Size: Supplied in 4.0m lengths.
- Material: PVC-u, Aluminium

 Gradus is the largest UK manufacturer of wall protection profiles

Components

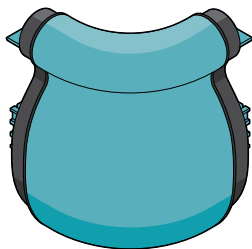

CHR1602
universal corner
(including reveals)

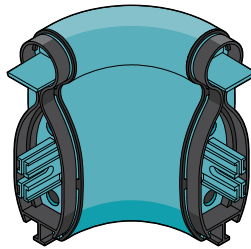

CHR1602
Universal corner
(including reveals)

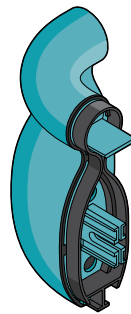

CHR1604L
left return
(including reveal)

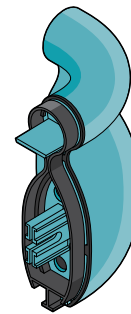

CHR1604R
right return
(including reveal)



CHR1603
mounting bracket
(supplied in colour 002 Gravel)

Features

Reduced ligature option available
continuous timber batten with
SureProtect Endure® strip

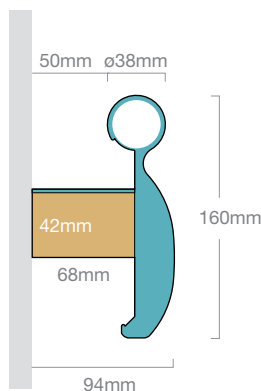
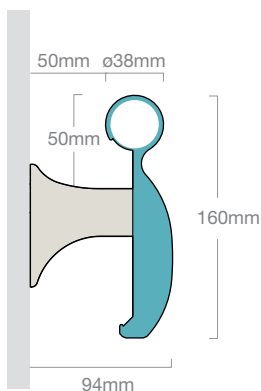

Profile

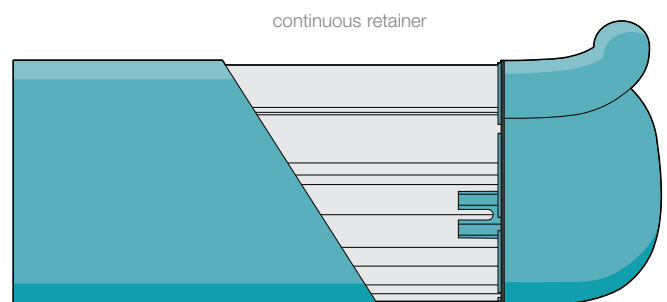

For multiple length installations use Wall Guard Splice D200JS



FLOORISTÁ

29/60 Moo 5 Soi Lumlooka 11/6
Lumlooka Rd. T.Kookot, A.Lumlooka
Pathumthani 12130 Thailand

Tel. +66(0)2. 995 7470
sales@vovgroup.com

call: +66(0).2 995 7470



This catalogue supersedes and replaces all previous issues.

All designs, images and illustrations contained within this catalogue remain the copyright of Gradus Ltd.©
All trademarks, product names and codes detailed within this catalogue are the property of Gradus Ltd.